

Site referred to in the application  
outlined Red  
Land belonging to the applicant  
outlined Blue

Scottish Borders Council  
Town And Country  
Planning (Scotland) Act  
1997

**REFUSED**

subject to the  
requirements of the  
associated Decision  
Notice

AH Aidan Hume Design Ltd  
Architectural Services

115 Channel Street  
Galashiels  
TD1 1BN

email:- Aidan.AHdesign@outlook.com  
tel:- 07782 592545 or 07783 420522

Project:  
PLOT 1  
PROPOSED DWELLING HOUSE,  
NORTH OF CAKEMUIR COTTAGE  
NENTHORN  
KELSO, TD5 7RY

Client:  
Mr & Mrs Forster

Title:  
LOCATION PLAN

Scale: 1 : 500 Paper size: A3 Drawn by: DP Date: 27.05.21

Project no: AH170 Drawing no: LP01 Issue: A

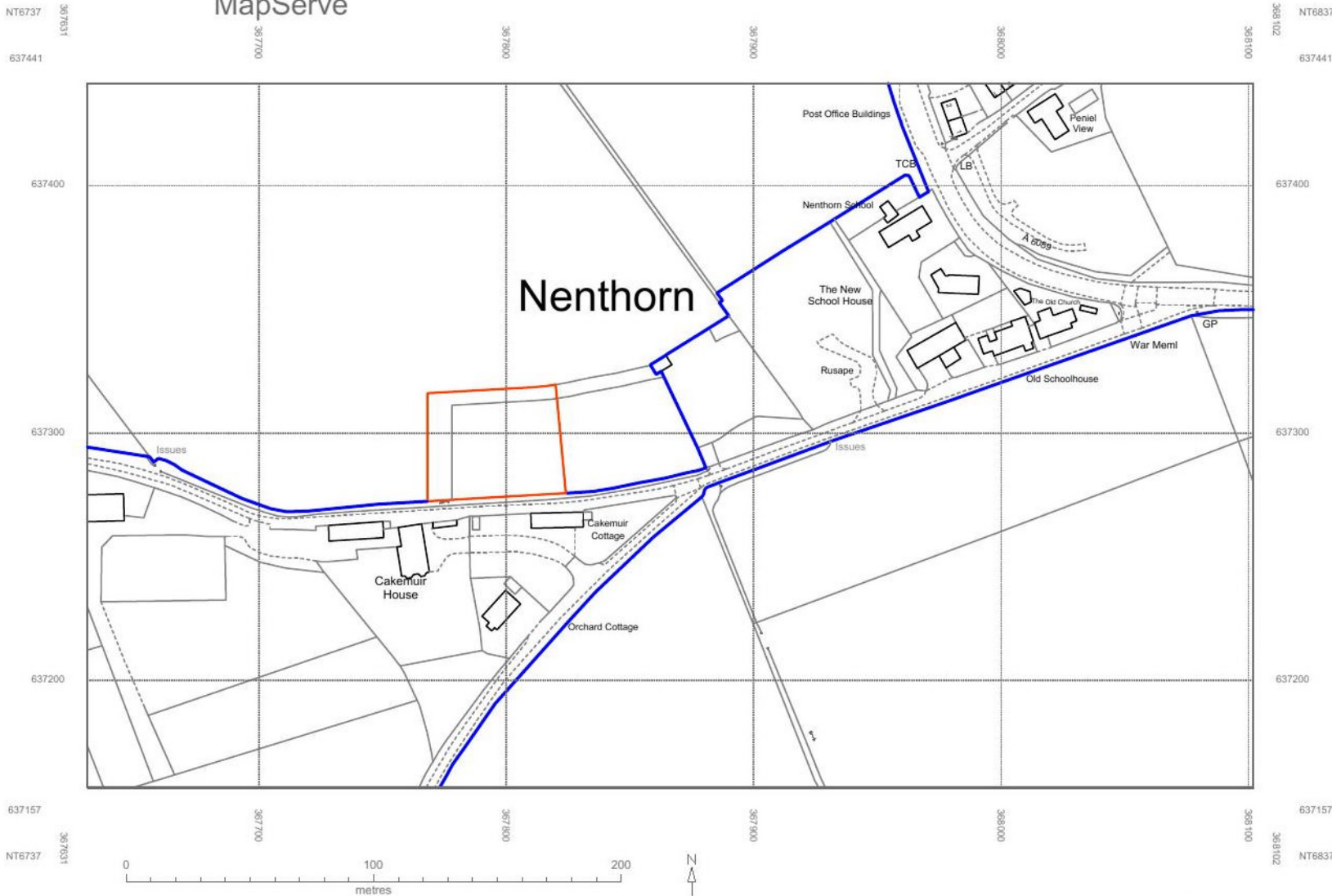

21/000999/PPP

01.09.2021

Scottish Borders Council  
Town And Country  
Planning (Scotland) Act  
1997

**REFUSED**

subject to the  
requirements of the  
associated Decision  
Notice



INDICATIVE HOUSE TYPE

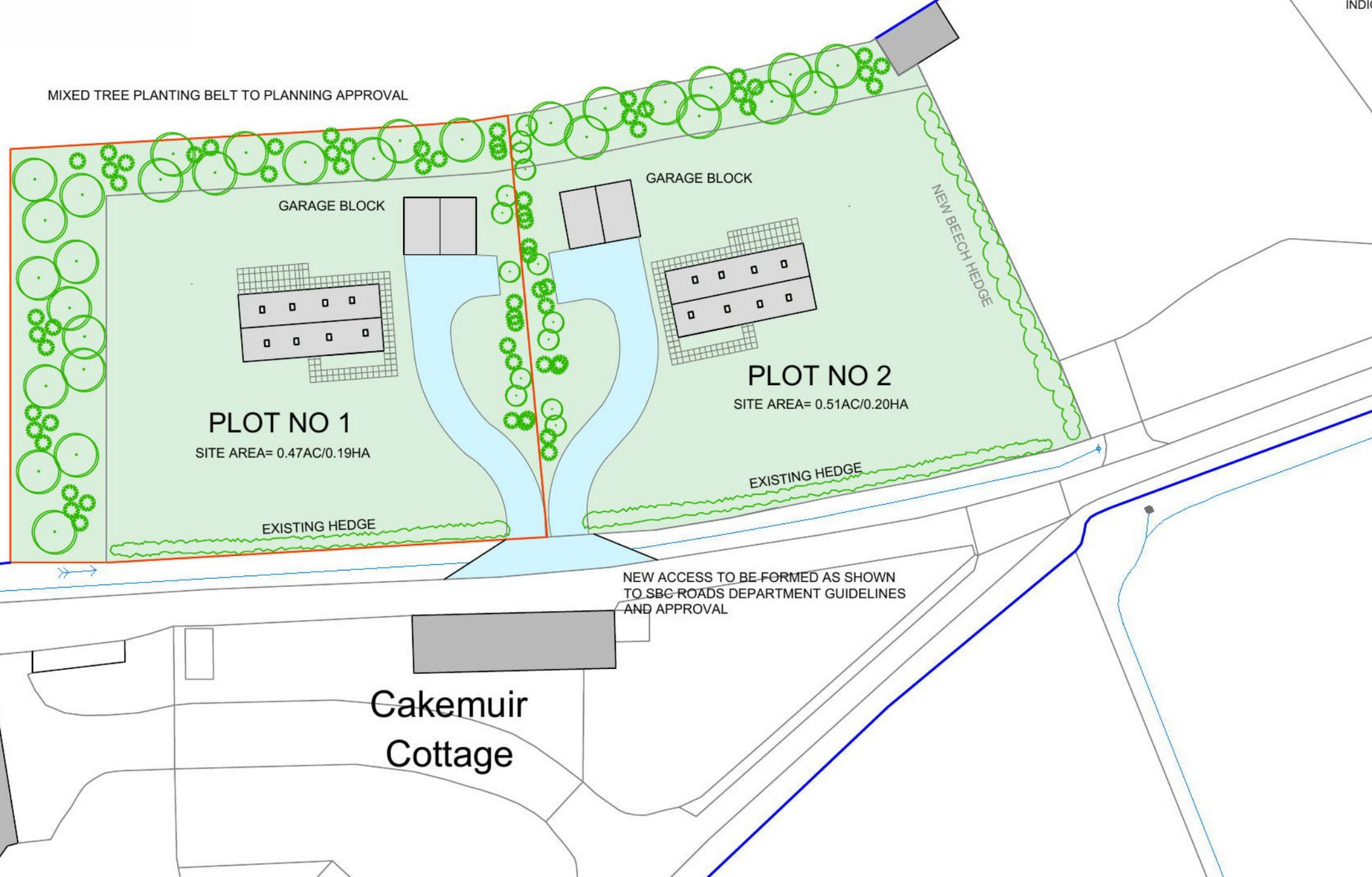

**AH** Aidan Hume Design Ltd  
Architectural Services

113 Channel Street  
Galashiels  
TD1 1BN  
email: aidan.ahdesign@outlook.com  
tel: 07792 59343 or 07788 420622

---

Project:  
PLOT 1  
PROPOSED DWELLING HOUSE,  
NORTH OF CAKEMUIR COTTAGE  
NENTHORN  
KELSO, TD5 7RY

---

Client:  
Mr & Mrs Forster

---

Title:  
SITE LAYOUT PLAN

---

Scale: 1 : 500	Paper size: A3	Drawn by: DP	Date: 14.06.21
-------------------	-------------------	-----------------	-------------------

---

Project no: AH170	Drawing no: SP02	Issue: A
----------------------	---------------------	-------------

© Aidan Hume Design Ltd. This drawing should not be copied or reproduced, or used for other than the stated project, without prior consent.